

Stepping Motors

M35SP-11NK

FEATURES

1. Thin, high resolution and high-output torque.
2. Superior running quietness and stability.

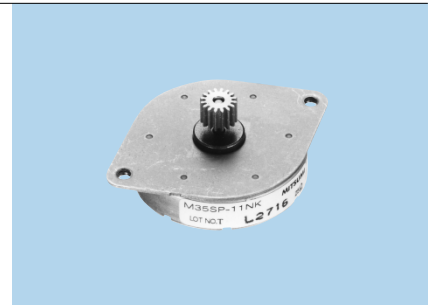

USES

Multifunction machines, scanners, etc.

SPECIFICATIONS

Item	M35SP-11NK
Rated Voltage	DC 24V
Working Voltage	DC 21.6~26.4V
Rated Current/Phase	360mA(PEAK)
Coil DC Resistance	15Ω/phase±10%
Step Angle	3.75°/step
Drive Method	Constant Current
Excitation Method	2-2 Phase excitation(Bipolar driving)
Insulation Class	Class E insulation
Holding Torque	11.8mN·m(0.23A/phase)
Pull-out Torque	8.8mN·m/3,000pps
Pull-in Torque	11.3mN·m/500pps
Max. Pull-out Pulse Rate	4,300pps
Max. Pull-in Pulse Rate	1,000pps

CHARACTERISTICS

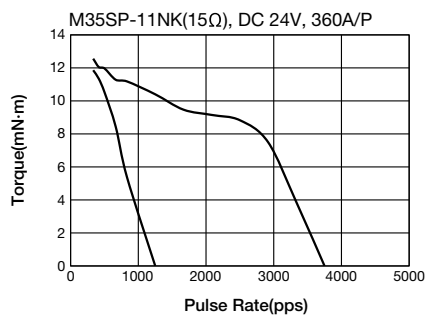

DIMENSIONS

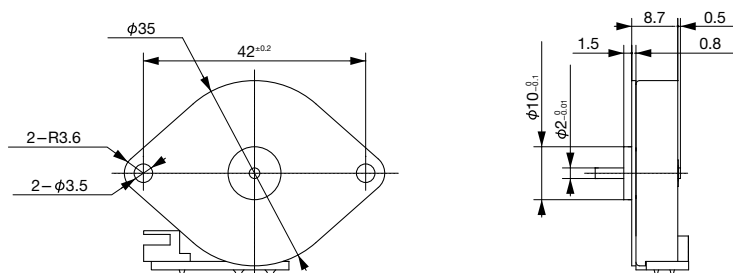

Unit : mm
General tolerance : ±0.5

• Any products mentioned in this catalog are subject to any modification in their appearance and others for improvements without prior notification.
• The details listed here are not a guarantee of the individual products at the time of ordering. When using the products, you will be asked to check their specifications.